

Low pressure solid stream nozzles Series 544

Properties:

- Concentrated solid stream jet
- High impact

Applications:

- Cleaning and washing processes
- Injection
- Targeted cooling
- Pasteurization



Series 544

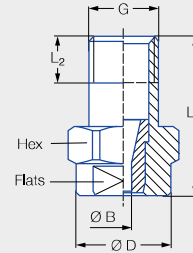

Code	G	Dimensions [mm]					Weight [g] (Brass)
		L ₁	L ₂	Ø D	Hex	Flats	
CA	1/8 BSPT	22.0	6.5	13.0	14	10	14.0
CC	1/4 BSPT	22.0	10.0	13.0	14	10	16.0

Type	Ordering no.		Code		Bore diameter B [mm]	V̇ water [l/min]								
	Mat. no.					p [bar]								
	16	30	1/8 BSPT	1/4 BSPT		0.5	1.0	2.0	3.0	5.0	10.0	15.0	20.0	30.0
	Stainless steel 303	Brass												
544.110	●	●	CA	CC	0.23	0.02	0.03	0.04	0.05	0.06	0.08	0.10	0.12	0.15
544.160	●		CA	CC	0.33	0.03	0.04	0.06	0.07	0.09	0.13	0.16	0.18	0.22
544.200	●	●	CA	CC	0.39	0.05	0.07	0.10	0.12	0.16	0.23	0.28	0.32	0.39
544.240	●		CA	CC	0.50	0.08	0.11	0.16	0.19	0.25	0.35	0.43	0.50	0.61
544.280	●		CA	CC	0.63	0.13	0.18	0.25	0.31	0.40	0.57	0.69	0.80	0.98
544.320	●	●	CA	CC	0.80	0.20	0.28	0.40	0.49	0.63	0.89	1.09	1.26	1.54
544.360	●	●	CA	CC	1.05	0.32	0.45	0.63	0.77	1.00	1.41	1.73	2.00	2.45
544.400	●	●	CA	CC	1.30	0.50	0.71	1.00	1.22	1.58	2.23	2.74	3.16	3.87
544.480	●	●	CA	CC	1.33	0.80	1.13	1.60	1.96	2.53	3.58	4.38	5.06	6.20
544.560	●	●	CA	CC	1.65	1.25	1.77	2.50	3.06	3.95	5.59	6.84	7.90	9.68
544.640	●	●	CA	CC	2.09	2.00	2.83	4.00	4.90	6.32	8.94	10.95	12.64	15.48
544.720	●	●	CA	CC	2.66	3.15	4.45	6.30	7.71	9.96	14.09	17.25	19.92	24.40
544.800	●	●	CA	CC	3.30	5.00	7.07	10.00	12.25	15.81	22.36	27.38	31.62	38.73

Conversion formula for this series: $\dot{V}_2 = \dot{V}_1 \cdot \sqrt{\frac{p_2}{p_1}}$

Ordering Type + Material no. + Code = Ordering no.
example: 544.110 + 16 + CA = 544.110.16.CA



Assembly accessories can be found in Chapter 9 "Accessories".