

# High impact cleaner IntenseClean Hygienic Series 5TA



## Features:

- High degree of effectiveness due to particularly powerful solid stream nozzles
- Suitable for smaller tanks with stubborn dirt
- Suitable for pressure levels up to 15 bar
- High surface quality



Series 5TA



**ATEX version available on request**

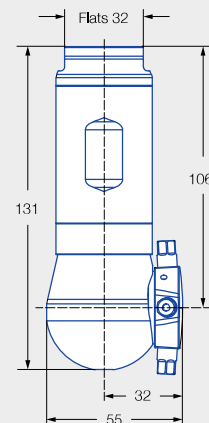
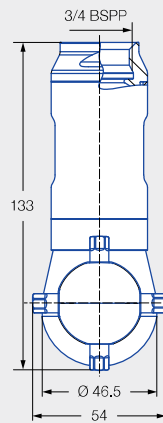
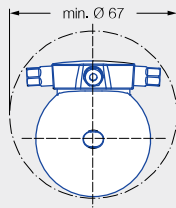

Female thread  
5TA.403.1Y.AL and 5TA.404.1Y.AL

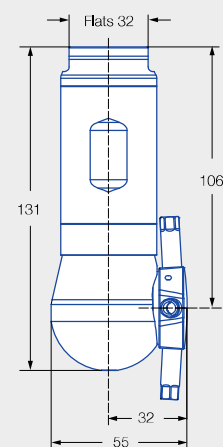
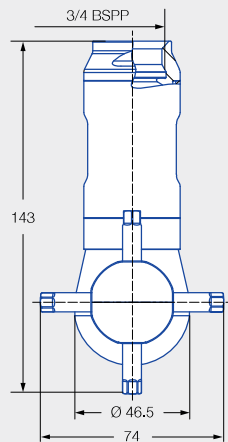
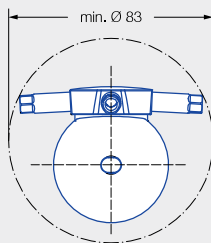

Female thread  
5TA.405.1Y.AL





<b>Max. tank diameter [m]</b>	0	3	6	9	12	15	18	21	24	27
-------------------------------	---	---	---	---	----	----	----	----	----	----

<b>Cleaning efficiency class</b> 5	<b>Max. temperature</b> 95°C	<b>Installation</b> Operation in every direction is possible	<b>Bearing</b> Ball bearing
<b>Material</b> Stainless steel 316L, stainless steel 632, PTFE, PEEK, zirconium oxide, EPDM	<b>Recommended operating pressure</b> 5 bar	<b>Filtration</b> Line strainer with a mesh size of 0.2 mm/80 mesh	<b>Rotation monitoring</b> Sensor compatible, for information: See Page 217
<b>Weight</b> 0.9 kg			

[www.lechler.com/intensecleanhygienic5ta](http://www.lechler.com/intensecleanhygienic5ta)  
Or scan the QR code.

Spray angle	Ordering no.	Narrowest free cross section Ø [mm]	Number, Ø Nozzles [mm]	V̇ water [l/min]				Max. tank diameter [m]
	Type			p [bar] (p <sub>max</sub> = 12 bar)				
				2.0	5.0	10.0	at 40 psi [US gal/min]	
360° 	<a href="#">5TA.403.1Y.AL</a>	1.5	4 × 3.0	24	<b>39</b>	55	8	12.0
	<a href="#">5TA.404.1Y.AL</a>	1.5	4 × 4.0	35	<b>56</b>	79	11	12.5
	<a href="#">5TA.405.1Y.AL</a>	1.5	4 × 5.0	50	<b>79</b>	111	16	13.0

NPT thread and slip-on connection available on request.

The maximum tank diameter applies to the recommended operating pressure and is meant as a recommendation only. The cleaning result is also affected by the type of soiling.

# High impact cleaner IntenseClean Hygienic Series 5TB



## Features:

- Extremely high degree of effectiveness due to particularly powerful solid stream nozzles
- High level of efficiency due to gear-controlled rotation
- Proven in the pharmaceutical and food and beverage industry
- Suitable for pressure levels up to 25 bar
- High surface quality



Series 5TB



**ATEX version available on request**

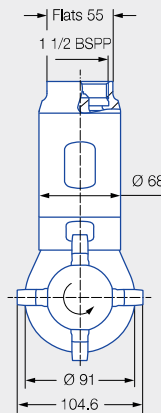
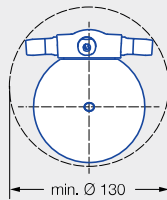

Female thread

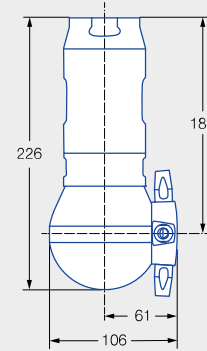

<b>Max. tank diameter [m]</b>	0	3	6	9	12	15	18	21	24	27
-------------------------------	---	---	---	---	----	----	----	----	----	----



**Cleaning efficiency class**  
5



**Max. temperature**  
95°C



**Installation**  
Operation in every direction is possible



**Bearing**  
Ball bearing



**Material**  
Stainless steel 316L, stainless steel 632, PTFE, PEEK, zirconium oxide, EPDM



**Recommended operating pressure**  
5 bar



**Filtration**  
Line strainer with a mesh size of 0,2 mm/80 mesh



**Rotation monitoring**  
Sensor compatible, for information: See Page 217



**Weight**  
4.0 kg

**Function video**

[www.lechler.com/intensecleanhygienic5tb](http://www.lechler.com/intensecleanhygienic5tb)  
Or scan the QR code.



Spray angle	Ordering no. Type	Narrowest free cross section Ø [mm]	Number, Ø Nozzles [mm]	V̇ water [l/min]				Max. tank diameter [m]
				p [bar] (p <sub>max</sub> = 15 bar)				
				2.0	5.0	10.0	at 40 psi [US gal/min]	
360° 	5TB.406.1Y.AS	6.0	4 × 6.0	107	169	239	33	14.0
	5TB.407.1Y.AS	6.0	4 × 7.0	132	209	296	41	14.0
	5TB.408.1Y.AS	6.0	4 × 8.0	150	238	336	47	15.0

NPT thread available on request.

The maximum tank diameter applies to the recommended operating pressure and is meant as a recommendation only. The cleaning result is also affected by the type of soiling.