

PTFE Rod Heaters GALMAFORM®

The PTFE rod heaters GALMAFORM are especially developed as direct electric heaters for the use in plants and tanks that demand a minimum physical size and an excellent resistance to aggressive process liquids. The very high chemical resistance is achieved by a special coating with PTFE (Polytetrafluorethylene).

The black PTFE compound coating of the rod heaters GALMAFORM (U-FC) improves the thermal conductivity and ensures a better transfer of the heat to the liquid. This allows a higher rated power, at the same physical dimensions compared to heaters with white PTFE coating.

The white PTFE coating of the rod heaters GALMAFORM (U-FK) is also suitable for clean-room applications and the food industry (physiological harmless). The pure white, electrically insulating PTFE coating prevents from metal reduction, and can therefore also be used for heating of autocatalytic (chemical) electrolytes.

The individual formability of the rods permits quick and variable installations. As the contact box and the cable can also be immersed in the process liquid, the heaters offer simple solutions for a wide range of requirements. The use of high-quality materials guarantees a long operating life-time with optimum reliability and failure free operation of your system.

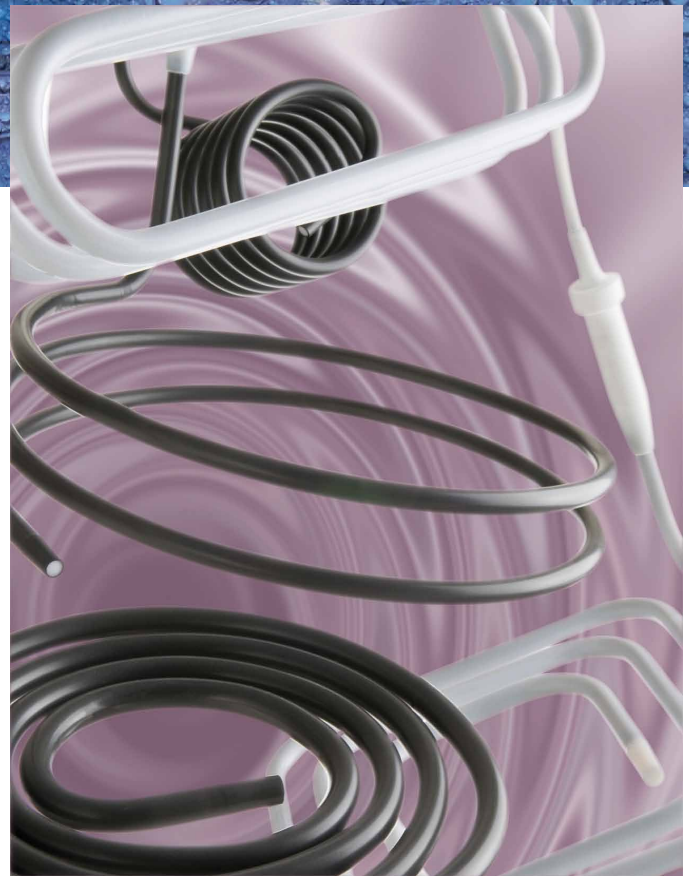

Construction

The rod heaters consist of a PTFE coated stainless steel heater tube with the electrical connections at one end. The contact box and the PTFE cable are welded together with a gas-tight seam, in order to allow a complete immersion.

The heated length of the rod (minimum immersion depth) is indicated by a permanent ring-shaped mark. The rod is not heated above this mark.

Even in applications where the liquid level varies greatly, the heated part of the rod must always be immersed!

The distance pieces ensure that the necessary distance between the rod heater and the wall of the tank is maintained. The UH support ensures secure mounting of the rod heater on the edge of the tank.

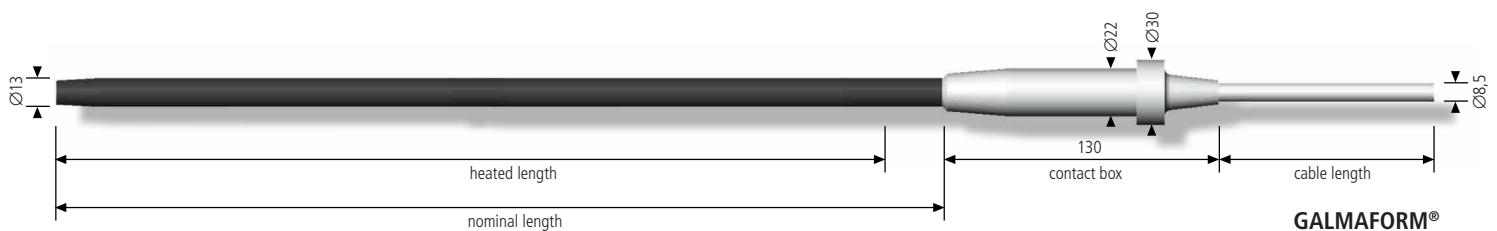

PTFE Rod Heaters GALMAFORM®

The universal formability of the rod heaters allows a wide range of installation variants. The various bending shapes of the rods are individually planned and implemented for you. Alternatively, you can bend the rods to the desired shape locally, matching them to the installation conditions. If so, the installation and operating instructions must be considered.

The available space can be optimally used by means of the various installation possibilities:

- on the tank wall
- on the floor of the tank (permits heating at very low liquid levels with optimum heat distribution)
- hanging freely in the tank

Electrical safety

In accordance with EN 60519-1/2, the heaters are classified as devices of protection class I. All metal parts are connected to the neutral conductor. The connection cable of the rod heaters GALMAFORM contains additionally a bare earth cable. If used together with an earth leakage circuit breaker (ELCB), the maximum possible electrical safety is ensured.

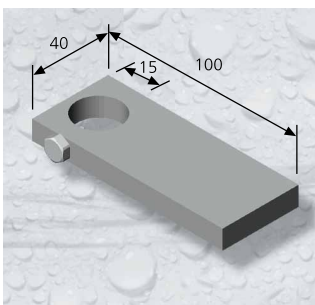

Support UH, material PVDF

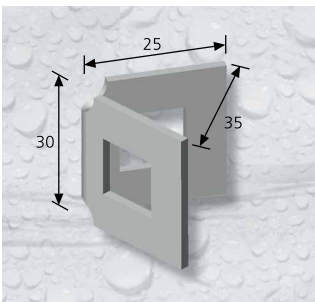

Distance piece AW 13, material PTFE, pure white

Technical data

	U-FC 25200	U-FK 25175	U-FK 14070
Rod coating	PTFE-Compound	PTFE, pure white	PTFE, pure white
Electrical conductivity of coating	yes	no	no
Rated power	2.000W	1.750W	700W
Surface loading	2,1W/cm ²	1,8W/cm ²	1,8W/cm ²
Rated voltage	230V~	230V~	230V~
Nominal length	2.500mm	2.500mm	1.400mm
Heated length	2.350mm	2.350mm	1.250mm
Cable length	2m	2m	2m
Rod diameter	Ø 13mm	Ø 13mm	Ø 13mm
Minimum bending radius	30mm	30mm	30mm
Accessories			
Support	UH	UH	UH
Distance piece	AW13	AW13	AW13